

Unit: mm

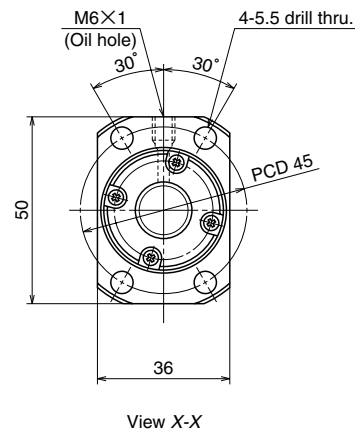

Ball screw specifications		
Product classification	Preloaded	Precise clearance
Shaft dia. X Lead / Direction of turn	15×20/Right	
Preload / Ball recirculation	P preload / End cap	
Ball dia. / Ball circle dia.	3.175/15.5	
Effective turns of balls	1.7×1	
Accuracy grade / Preload / Axial play	C5/Z	C5/T
Basic load rating (N)	Dynamic C_a	3870
	Static C_{0a}	5820
Axial play	0	0.005 or less
Dynamic friction torque, (N·cm)	1.5~7.8	~2.4
Spacer ball	Yes	None
Factory packed grease	NSK grease LR3	
Internal spatial volume of nut (cm ³)	1.9	

Ball screw No.		Stroke	
		Nominal	Maximum (L ₁ -Nut length)
Preloaded (UPFC)	Precise clearance (USFC)		
W1501FA-3PG-C5Z20	W1501FA-4G-C5T20	100	141
W1502FA-5PG-C5Z20	W1502FA-6G-C5T20	150	191
W1502FA-7PG-C5Z20	W1502FA-8G-C5T20	200	241
W1503FA-5PG-C5Z20	W1503FA-6G-C5T20	250	291
W1503FA-7PG-C5Z20	W1503FA-8G-C5T20	300	341
W1504FA-5PG-C5Z20	W1504FA-6G-C5T20	350	391
W1504FA-7PG-C5Z20	W1504FA-8G-C5T20	400	441
W1505FA-5PG-C5Z20	W1505FA-6G-C5T20	450	491
W1505FA-7PG-C5Z20	W1505FA-8G-C5T20	500	541
W1506FA-5PG-C5Z20	W1506FA-6G-C5T20	550	591
W1506FA-7PG-C5Z20	W1506FA-8G-C5T20	600	641
W1507FA-3PG-C5Z20	W1507FA-4G-C5T20	700	741
W1508FA-3PG-C5Z20	W1508FA-4G-C5T20	800	841
W1510FA-3PG-C5Z20	W1510FA-4G-C5T20	1000	1041

- Remarks
- We recommend NSK support unit WBK12-01A (square type, fixed side), WBK12S-01 (square type, simple support side), and WBK12-11 (round type, fixed side).
 - NSK grease LR3 is recommended. The amount for replenishing should be about 50% of nut internal space capacity.
 - Permissible rotational speed is determined by a $d \cdot n$ value and a critical speed. See page B509. Root diameter of screw shaft (dr) is 12.2 mm.

Unit: mm

Screw shaft length			Lead accuracy			Shaft run-out **	Mass (Kg)	Permissible rotational speed N (min ⁻¹)	
								Supporting condition	
L ₁	L ₂	L ₃	T	e _p	v _a		Fixed - Simple support	Fixed - Fixed	
186	204	271	0	0.020	0.018	0.025	0.61	3000	3000
236	254	321	0	0.023	0.018	0.035	0.68	3000	3000
286	304	371	0	0.023	0.018	0.035	0.75	3000	3000
336	354	421	0	0.025	0.020	0.040	0.81	3000	3000
386	404	471	0	0.025	0.020	0.040	0.88	3000	3000
436	454	521	0	0.027	0.020	0.050	0.95	3000	3000
486	504	571	0	0.027	0.020	0.050	1.0	3000	3000
536	554	621	0	0.030	0.023	0.050	1.1	3000	3000
586	604	671	0	0.030	0.023	0.065	1.1	3000	3000
636	654	721	0	0.035	0.025	0.065	1.2	3000	3000
686	704	771	0	0.035	0.025	0.065	1.3	3000	3000
786	804	871	0	0.035	0.025	0.085	1.4	3000	3000
886	904	971	0	0.040	0.027	0.085	1.5	2400	3000
1086	1104	1171	0	0.046	0.030	0.110	1.8	1590	2240