

| Ball screw No. | | Stroke | |
|---------------------------|--------------------------|---------|--------------------------------------|
| | | Nominal | Maximum (L ₁ -Nut length) |
| Preloaded (UPFC) | Precise clearance (USFC) | | |
| W1603FA-7PGX-C5Z32 | W1603FA-8GX-C5T32 | 300 | 348 |
| W1605FA-5PGX-C5Z32 | W1605FA-6GX-C5T32 | 500 | 548 |
| W1608FA-5PGX-C5Z32 | W1608FA-6GX-C5T32 | 800 | 848 |
| W1612FA-1PGX-C5Z32 | W1612FA-2GX-C5T32 | 1200 | 1248 |

- Remarks
1. We recommend NSK support unit WBK12-01A (square type, fixed side), WBK12S-01 (square type, simple support side), and WBK12-11 (round type, fixed side).
 2. NSK grease LR3 is recommended. The amount for replenishing should be about 50% of nut internal space capacity.
 3. Nut does not have a seal.
 4. Permissible rotational speed is determined by a $d \cdot n$ value and a critical speed. See page B509.
Root diameter of screw shaft (dr) is 13.4 mm.

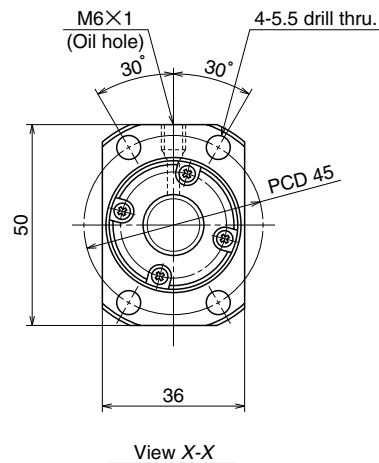

Unit: mm

| Ball screw specifications | | |
|---|------------------------|-------------------|
| Product classification | Preloaded | Precise clearance |
| Shaft dia. X Lead / Direction of turn | 16×32/Right | |
| Preload / Ball recirculation | P preload / End cap | |
| Ball dia. / Ball circle dia. | 3.175/16.75 | |
| Effective turns of balls | 0.7×2 | |
| Accuracy grade / Preload / Axial play | C5/Z | C5/T |
| Basic load rating (N) | Dynamic C _a | 4000 |
| | Static C _{0a} | 6690 |
| Axial play | 0 | 0.005 or less |
| Dynamic friction torque, (N·cm) | 1.5~9.8 | ~2.4 |
| Spacer ball | None | |
| Factory packed grease | NSK grease LR3 | |
| Internal spatial volume of nut (cm ³) | 2.0 | |

Unit: mm

| Screw shaft length | | | Lead accuracy | | | Shaft run-out ** | Mass (Kg) | Permissible rotational speed N (min ⁻¹) | |
|--------------------|----------------|----------------|---------------|----------------|----------------|------------------|------------------------|---|------|
| | | | | | | | | Supporting condition | |
| L ₁ | L ₂ | L ₃ | T | e _p | v ₀ | | Fixed - Simple support | Fixed - Fixed | |
| 382 | 404 | 471 | 0 | 0.025 | 0.020 | 0.040 | 0.90 | 3000 | 3000 |
| 582 | 604 | 671 | 0 | 0.030 | 0.023 | 0.065 | 1.2 | 3000 | 3000 |
| 882 | 904 | 971 | 0 | 0.040 | 0.027 | 0.085 | 1.7 | 2630 | 3000 |
| 1282 | 1304 | 1371 | 0 | 0.054 | 0.035 | 0.150 | 2.3 | 1240 | 1740 |