

Unit: mm

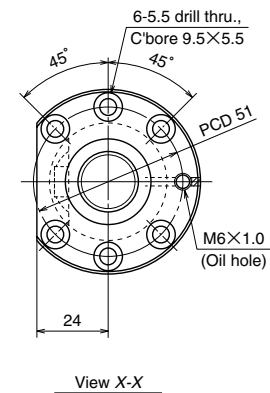

Ball screw specifications		
Shaft dia. X Lead / Direction of turn	20 × 4/Right	
Preload / Ball recirculation	P preload / Return tube	
Ball dia. / Ball circle dia.	2.381/20.3	
Effective turns of balls	2.5 × 2	
Accuracy grade / Preload	C5/Z	
Basic load rating (N)	Dynamic C _a	5420
	Static C _{0a}	10700
Preload (N)	294	
Dynamic friction torque, median, (N · cm)	3.9	
Spacer ball	Yes	
Factory packed grease	Refer to Remarks 2.	
Internal spatial volume of nut (cm ³)	2.7	

Ball screw No.	Stroke		Screw shaft length		
	Nominal	Maximum (L ₁ -Nut length)	L ₁	L ₂	L ₃
W2002SA-1P-C5Z4	150	176	225	250	335
W2002SA-2P-C5Z4	200	226	275	300	385
W2003SA-1P-C5Z4	300	326	375	400	485
W2004SA-1P-C5Z4	400	426	475	500	585
W2005SA-1P-C5Z4	500	526	575	600	685
W2006SA-1P-C5Z4	600	626	675	700	785

Remarks 1. We recommend NSK support unit WBK15-01A (square type, fixed side), WBK15S-01 (square type, simple support side), and WBK15-11 (round type, fixed side).
 2. **Only rust preventive agent is applied at time of delivery. Please apply lubricant (oil or grease) before use.**
 3. Permissible rotational speed is determined by a d · n value and a critical speed. See page B509.
 Root diameter of screw shaft (dr) is 17.8 mm.

Lead accuracy			Shaft run-out **	Mass (Kg)	Permissible rotational speed N (min ⁻¹)	
T	e _p	v _u			Supporting condition	
					Fixed - Simple support	Fixed - Fixed
-0.005	0.023	0.018	0.045	1.1	3000	3000
-0.007	0.023	0.018	0.045	1.2	3000	3000
-0.009	0.025	0.020	0.055	1.5	3000	3000
-0.011	0.027	0.020	0.070	1.7	3000	3000
-0.014	0.030	0.023	0.085	1.9	3000	3000
-0.016	0.035	0.025	0.085	2.1	3000	3000

Unit: mm