

Unit: mm

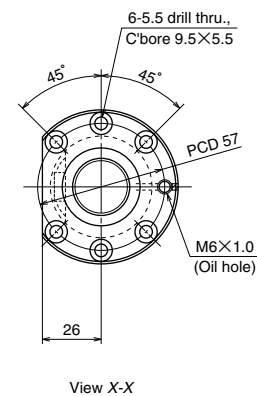

Ball screw specifications		
Shaft dia. x Lead / Direction of turn	25 x 4 / Right	
Preload / Ball recirculation	P preload / Return tube	
Ball dia. / Ball circle dia.	2.381 / 25.3	
Effective turns of balls	2.5 x 2	
Accuracy grade / Preload	C5/Z	
Basic load rating (N)	Dynamic C_a	6020
	Static C_{0a}	13600
Preload (N)	290	
Dynamic friction torque, median, (N·cm)	4.9	
Spacer ball	Yes	
Factory packed grease	Refer to Remarks 2.	
Internal spatial volume of nut (cm ³)	3.2	

Ball screw No.	Stroke		Screw shaft length		
	Nominal	Maximum (L ₁ -Nut length)	L ₁	L ₂	L ₃
W2502SA-1P-C5Z4	150	172	220	250	349
W2502SA-2P-C5Z4	200	222	270	300	399
W2503SA-1P-C5Z4	300	322	370	400	499
W2504SA-1P-C5Z4	400	422	470	500	599
W2505SA-1P-C5Z4	500	522	570	600	733
W2507SA-1P-C5Z4	700	722	770	800	933

Left side shaft end	Lead accuracy			Shaft run-out **	Mass (Kg)	Permissible rotational speed N (min ⁻¹)	
	T	e _p	v _u			Supporting condition	
						Fixed - Simple support	Fixed - Fixed
II	-0.005	0.023	0.018	0.035	1.6	2800	—
II	-0.006	0.023	0.018	0.035	1.8	2800	—
II	-0.009	0.025	0.020	0.040	2.2	2800	—
II	-0.011	0.027	0.020	0.050	2.5	2800	—
I	-0.014	0.030	0.023	0.060	3.0	2800	2800
I	-0.018	0.035	0.025	0.075	3.7	2800	2800

- Remarks
1. We recommend NSK support unit WBK20-01A (square type, fixed side), WBK20S-01 (square type, simple support side), and WBK20-11 (round type, fixed side).
 2. Only rust preventive agent is applied at time of delivery. Please apply lubricant (oil or grease) before use.
 3. Permissible rotational speed is determined by a $d \cdot n$ value and a critical speed. See page B509.
Root diameter of screw shaft (dr) is 22.8 mm.