

A Series: Finished shaft end

(Fine lead) Dia. 32, Lead 6

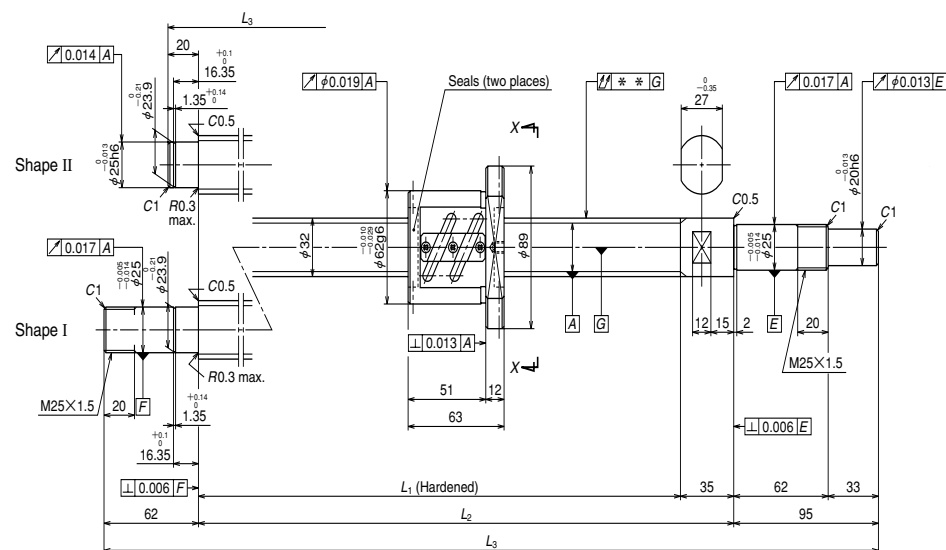

Nut models: PFT

NSK

φ 32 × 6



Unit: mm

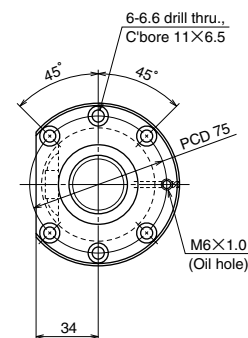

Ball screw specifications		
Shaft dia. × Lead / Direction of turn	32 × 6 / Right	
Preload / Ball recirculation	P preload / Return tube	
Ball dia. / Ball circle dia.	3.969 / 32.5	
Effective turns of balls	2.5 × 2	
Accuracy grade / Preload	C5 / Z	
Basic load rating (N)	Dynamic C_a	15500
	Static C_{0a}	34700
Preload (N)	780	
Dynamic friction torque, median, (N · cm)	15.7	
Spacer ball	Yes	
Factory packed grease	Refer to Remarks 2.	
Internal spatial volume of nut (cm ³)	9.5	

Ball screw No.	Stroke		Screw shaft length		
	Nominal	Maximum (L_1 -Nut length)	L_1	L_2	L_3
W3203SA-3P-C5Z6	250	302	365	400	515
W3205SA-3P-C5Z6	450	502	565	600	715
W3207SA-3P-C5Z6	650	702	765	800	957
W3209SA-3P-C5Z6	850	902	965	1000	1157
W3211SA-3P-C5Z6	1050	1102	1165	1200	1357
W3214SA-3P-C5Z6	1350	1402	1465	1500	1657

Remarks 1. We recommend NSK support unit WBK25-01 (square type, fixed side), WBK25S-01 (square type, simple support side), and WBK25-11 (round type, fixed side).

2. Only rust preventive agent is applied at time of delivery. Please apply lubricant (oil or grease) before use.

3. Permissible rotational speed is determined by a $d \cdot n$ value and a critical speed. See page B509.

Root diameter of screw shaft (d_r) is 28.4 mm.

Left side shaft end	Lead accuracy			Shaft run-out **	Mass (Kg)	Permissible rotational speed N (min ⁻¹)	
	T	e_p	v_u			Supporting condition	
	Fixed - Simple support		Fixed - Fixed				
II	-0.009	0.025	0.020	0.050	3.8	2180	—
II	-0.014	0.030	0.023	0.060	5.0	2180	—
I	-0.018	0.035	0.025	0.075	6.3	2180	2180
I	-0.023	0.040	0.027	0.090	7.4	2180	2180
I	-0.028	0.046	0.030	0.120	8.5	2180	2180
I	-0.035	0.054	0.035	0.150	10.2	2020	2180

Unit: mm

B
120