

Unit: mm

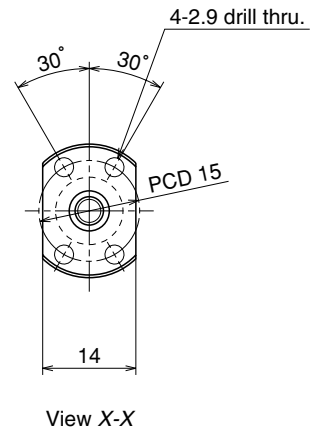

Ball screw specifications		
Product classification	Preloaded	Precise clearance
Shaft dia. X Lead / Direction of turn	4×1 / Right	
Preload / Ball recirculation	P preload / Deflector	
Ball dia. / Ball circle dia.	0.800 / 4.2	
Effective turns of balls	1×2	
Accuracy grade / Preload / Axial play	C3 / Z	C3 / T
Basic load rating (N)	Dynamic C_a	315
	Static C_{0a}	370
Axial play	0	0.005 or less
Dynamic friction torque, (N·cm)	~1.0	~0.3
Spacer ball	None	
Factory packed grease	NSK grease PS2	

Ball screw No.		Stroke	
		Nominal	Maximum (L ₁ -Nut length)
Preloaded (MPFD)	Precise clearance (MSFD)		
W0400MA-1PY-C3Z1	W0400MA-2Y-C3T1	20	32
W0400MA-3PY-C3Z1	W0400MA-4Y-C3T1	40	52
W0401MA-1PY-C3Z1	W0401MA-2Y-C3T1	70	82

- Remarks: 1. We recommend NSK support unit WBK06-01A (square type, fixed side) or WBK06-11 (round type, fixed side).
 2. NSK grease PS2 is recommended. Apply to the screw shaft surface when replenishing.
 3. Nut does not have a seal.
 4. Permissible rotational speed is determined by a $d \cdot n$ value and a critical speed. See page B509.
 Root diameter of screw shaft (dr) is 3.2 mm.

Unit: mm

Screw shaft length			Lead accuracy			Shaft run-out **	Mass (Kg)	Permissible rotational speed N (min ⁻¹)
L_1	L_2	L_3	T	e_p	v_u			Supporting condition
								Fixed - Free
44	55	85	0	0.008	0.008	0.015	0.024	3000
64	75	105	0	0.008	0.008	0.020	0.026	3000
94	105	135	0	0.008	0.008	0.025	0.028	3000