

### A Series: Finished shaft end

(Fine lead) Dia. 50, Lead 10

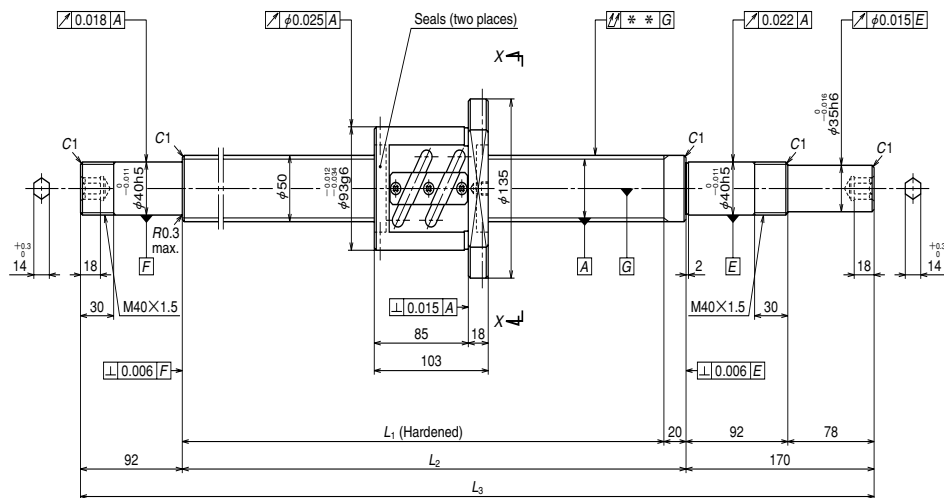

### Nut models: ZFT

NSK

$\phi 50 \times 10$



Unit: mm

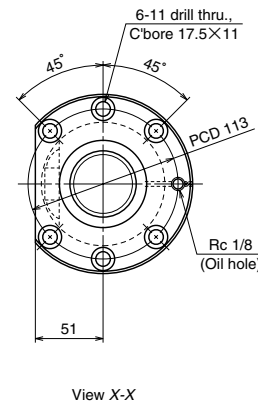

Ball screw specifications		
Shaft dia. X Lead / Direction of turn	50 X 10/Right	
Preload / Ball recirculation	Z preload / Return tube	
Ball dia. / Ball circle dia.	6.35/51	
Effective turns of balls	2.5 X 1	
Accuracy grade / Preload	C5/Z	
Basic load rating (N)	Dynamic C <sub>a</sub>	31800
	Static C <sub>0a</sub>	87400
Preload (N)	2450	
Dynamic friction torque, median, (N · cm)	79.0	
Spacer ball	None	
Factory packed grease	<b>Refer to Remarks 2.</b>	
Internal spatial volume of nut (cm <sup>3</sup> )	37	

Ball screw No.	Stroke		Screw shaft length		
	Nominal	Maximum (L <sub>1</sub> -Nut length)	L <sub>1</sub>	L <sub>2</sub>	L <sub>3</sub>
<b>W5005SA-1Z-C5Z10</b>	450	477	580	600	862
<b>W5007SA-1Z-C5Z10</b>	650	677	780	800	1062
<b>W5009SA-1Z-C5Z10</b>	850	877	980	1000	1262
<b>W5011SA-1Z-C5Z10</b>	1050	1077	1180	1200	1462
<b>W5014SA-1Z-C5Z10</b>	1350	1377	1480	1500	1762
<b>W5019SA-1Z-C5Z10</b>	1850	1877	1980	2000	2262
<b>W5025SA-1Z-C5Z10</b>	2450	2477	2580	2600	2862

- Remarks
- We recommend NSK support unit round type WBK40DF-31.
  - Only rust preventive agent is applied at time of delivery. Please apply lubricant (oil or grease) before use.**
  - Permissible rotational speed is determined by a  $d \cdot n$  value and a critical speed. See page B509.  
Root diameter of screw shaft (dr) is 44.4 mm.

Lead accuracy			Shaft run-out **	Mass (Kg)	Permissible rotational speed N (min <sup>-1</sup> )	
T	e <sub>p</sub>	v <sub>u</sub>			Supporting condition	
					Fixed - Simple support	Fixed - Fixed
-0.014	0.030	0.023	0.050	14.8	1400	1400
-0.019	0.035	0.025	0.065	17.6	1400	1400
-0.024	0.040	0.027	0.080	20.3	1400	1400
-0.028	0.046	0.030	0.080	23.1	1400	1400
-0.036	0.054	0.035	0.100	27.3	1400	1400
-0.048	0.065	0.040	0.130	34.2	1400	1400
-0.062	0.093	0.054	0.170	42.5	1020	1400

Unit: mm