

Unit: mm

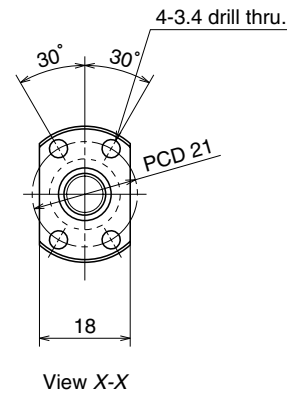

Ball screw specifications		
Product classification	Preloaded	Precise clearance
Shaft dia. X Lead / Direction of turn	8×1/Right	
Preload / Ball recirculation	P preload / Deflector	
Ball dia. / Ball circle dia.	0.800/8.2	
Effective turns of balls	1×3	
Accuracy grade / Preload / Axial play	C3/Z	C3/T
Basic load rating (N)	Dynamic C_a	670
	Static C_{0a}	1290
Axial play	0	0.005 or less
Dynamic friction torque, (N·cm)	~1.8	~0.5
Spacer ball	None	
Factory packed grease	NSK grease PS2	

Ball screw No.		Stroke	
		Nominal	Maximum (L ₁ -Nut length)
Preloaded (MPFD)	Precise clearance (MSFD)		
W0800MA-1PY-C3Z1	W0800MA-2Y-C3T1	40	64
W0801MA-1PY-C3Z1	W0801MA-2Y-C3T1	70	94
W0801MA-3PY-C3Z1	W0801MA-4Y-C3T1	100	124
W0802MA-1PY-C3Z1	W0802MA-2Y-C3T1	150	174

- Remarks
1. We recommend NSK support unit WBK08-01A (square type, fixed side), WBK08S-01 (square type, simple support side), and WBK08-11 (round type, fixed side).
 2. NSK grease PS2 is recommended. Apply to the screw shaft surface when replenishing.
 3. Nut does not have a seal.
 4. Permissible rotational speed is determined by a $d \cdot n$ value and a critical speed. See page B509. Root diameter of screw shaft (dr) is 7.2 mm.

Unit: mm

Screw shaft length			Lead accuracy			Shaft run-out **	Mass (Kg)	Permissible rotational speed N (min ⁻¹)
L ₁	L ₂	L ₃	T	e _p	v _u			Supporting condition
80	92	138	0	0.008	0.008	0.025	0.073	3000
110	122	168	0	0.010	0.008	0.030	0.084	3000
140	152	198	0	0.010	0.008	0.030	0.095	3000
190	202	248	0	0.010	0.008	0.035	0.11	3000