

Unit: mm

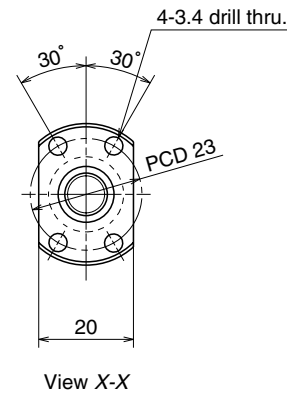

Ball screw specifications		
Product classification	Preloaded	Precise clearance
Shaft dia. X Lead / Direction of turn	8×2/Right	
Preload / Ball recirculation	P preload / Deflector	
Ball dia. / Ball circle dia.	1.200/8.3	
Effective turns of balls	1×3	
Accuracy grade / Preload / Axial play	C3/Z	C3/T
Basic load rating (N)	Dynamic C_a	1320
	Static C_{0a}	2210
Axial play	0	0.005 or less
Dynamic friction torque, (N·cm)	~2.0	~0.5
Spacer ball	None	
Factory packed grease	NSK grease PS2	

Ball screw No.		Stroke	
		Nominal	Maximum (L ₁ -Nut length)
Preloaded (MPFD)	Precise clearance (MSFD)		
W0800MA-5PY-C3Z2	W0800MA-6Y-C3T2	40	54
W0801MA-9PY-C3Z2	W0801MA-10Y-C3T2	70	84
W0801MA-11PY-C3Z2	W0801MA-12Y-C3T2	100	114
W0802MA-5PY-C3Z2	W0802MA-6Y-C3T2	150	164

- Remarks
- We recommend NSK support unit WBK08-01A (square type, fixed side), WBK08S-01 (square type, simple support side), and WBK08-11 (round type, fixed side).
 - NSK grease PS2 is recommended. Apply to the screw shaft surface when replenishing.
 - Permissible rotational speed is determined by a $d \cdot n$ value and a critical speed. See page B509. Root diameter of screw shaft (dr) is 6.9 mm.

Unit: mm

Screw shaft length			Lead accuracy			Shaft run-out **	Mass (Kg)	Permissible rotational speed N (min ⁻¹)
L ₁	L ₂	L ₃	T	e _p	v _u			Supporting condition
								Fixed - Simple support
80	92	138	0	0.008	0.008	0.025	0.09	3000
110	122	168	0	0.010	0.008	0.030	0.10	3000
140	152	198	0	0.010	0.008	0.030	0.11	3000
190	202	248	0	0.010	0.008	0.035	0.13	3000