

Ball screw No.	Stroke		Thread length			
	Nominal	Maximum	L_1	L_2	L_3	L_4
W1002KA-3PY-C3Z2	200	203	250	254	262	308

- Remarks
1. Only rust preventive agent is applied at time of delivery. Please apply lubricant (oil or grease) before use. NSK Clean Grease LG2 is recommended.
 2. Permissible rotational speed is determined by a $d \cdot n$ value and a critical speed. See page B509. Root diameter of screw shaft (d_r) is 8.9 mm.

Unit: mm

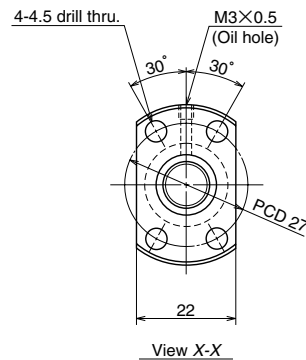

Ball screw specifications		
Shaft dia. x Lead / Direction of turn	10 x 2 / Right	
Preload / Ball recirculation	P preload / Deflector	
Ball dia. / Ball circle dia.	1.200 / 10.3	
Effective turns of balls	1 x 3	
Accuracy grade / Preload	C3/Z	
Basic load rating (N)	Dynamic C_a	1210
	Static C_{0a}	2110
Axial play	0	
Dynamic friction torque, (N · cm)	0.10 ~ 2.5	
Spacer ball	None	
Factory packed grease	Refer to the remarks 1. below.	

Unit: mm

Lead accuracy			Shaft run-out **	Mass (Kg)	Permissible rotational speed N (min ⁻¹)
T	e_p	v_u			Supporting condition
0	0.012	0.008	0.030	0.22	Fixed - Simple support 3000