

Unit: mm

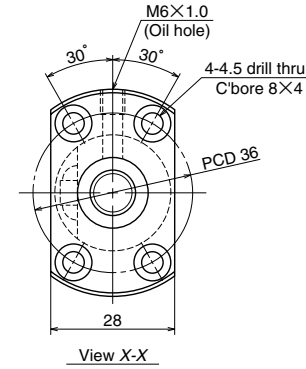
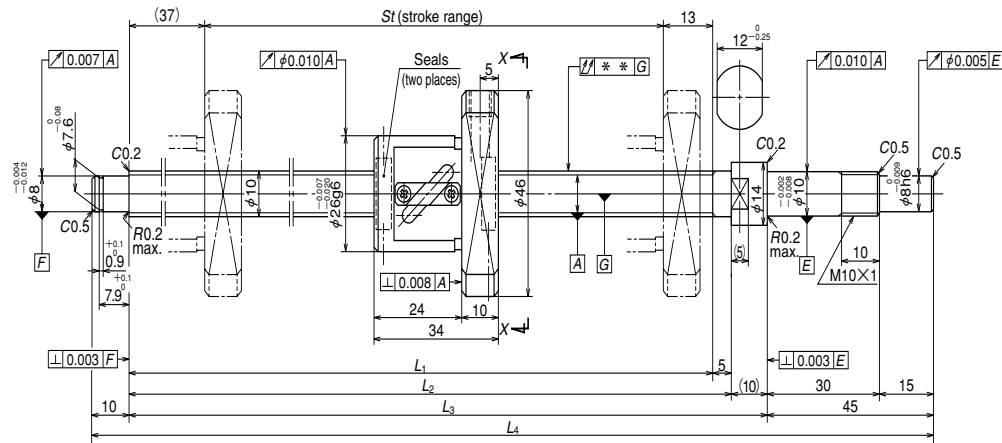

| Ball screw specifications | | |
|---|--------------------------------|------|
| Shaft dia. x Lead / Direction of turn | 10 x 4 / Right | |
| Preload / Ball recirculation | P preload / Return tube | |
| Ball dia. / Ball circle dia. | 2.000 / 10.3 | |
| Effective turns of balls | 2.5 x 1 | |
| Accuracy grade / Preload | C3/Z | |
| Basic load rating (N) | Dynamic C_a | 2250 |
| | Static C_{0a} | 3290 |
| Axial play | 0 | |
| Dynamic friction torque, (N·cm) | 0.5~3.9 | |
| Spacer ball | None | |
| Factory packed grease | Refer to the remarks 1. below. | |
| Internal spatial volume of nut (cm ³) | 0.8 | |

| Ball screw No. | Stroke | | Thread length | | | |
|-----------------|---------|---------|---------------|-------|-------|-------|
| | Nominal | Maximum | L_1 | L_2 | L_3 | L_4 |
| W1001KA-3P-C3Z4 | 100 | 110 | 160 | 165 | 175 | 230 |
| W1003KA-3P-C3Z4 | 300 | 310 | 360 | 365 | 375 | 430 |

| Lead accuracy | | | Shaft run-out ** | Mass (Kg) | Permissible rotational speed N (min ⁻¹) |
|---------------|-------|-------|------------------|-----------|---|
| T | e_p | v_u | | | Supporting condition |
| 0 | 0.010 | 0.008 | 0.030 | 0.29 | 3000 |
| 0 | 0.013 | 0.008 | 0.050 | 0.39 | 3000 |

Remarks 1. Only rust preventive agent is applied at time of delivery. Please apply lubricant (oil or grease) before use. NSK Clean Grease LG2 is recommended.
 2. Permissible rotational speed is determined by a $d \cdot n$ value and a critical speed. See page B509. Root diameter of screw shaft (dr) is 8.2 mm.