

Unit: mm

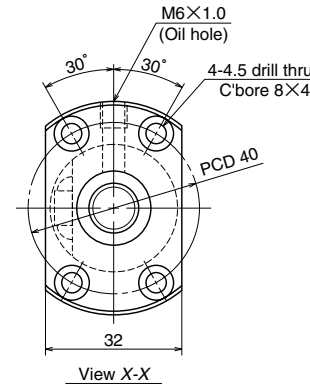

Ball screw specifications		
Shaft dia. X Lead / Direction of turn	12 X 10/Right	
Preload / Ball recirculation	P preload / Return tube	
Ball dia. / Ball circle dia.	2.381/12.5	
Effective turns of balls	2.5 X 1	
Accuracy grade / Preload	C5/Z	
Basic load rating (N)	Dynamic C_a	3070
	Static C_{0a}	4790
Axial play	0	
Dynamic friction torque, (N · cm)	1.0 ~ 4.9	
Spacer ball	None	
Factory packed grease	Refer to the remarks 1. below.	
Internal spatial volume of nut (cm ³)	1.4	



Ball screw No.	Stroke		Thread length			
	Nominal	Maximum	L_1	L_2	L_3	L_4
W1203KA-3P-C5Z10	250	253	310	315	325	380
W1205KA-3P-C5Z10	450	453	510	515	525	580

Lead accuracy			Shaft run-out **	Mass (Kg)	Permissible rotational speed N (min ⁻¹)
T	e_p	v_u			Supporting condition
0	0.023	0.018	0.050	0.56	3000
0	0.030	0.023	0.075	0.72	3000

Remarks 1. Only rust preventive agent is applied at time of delivery. Please apply lubricant (oil or grease) before use. NSK Clean Grease LG2 is recommended.
 2. Permissible rotational speed is determined by a $d \cdot n$ value and a critical speed. See page B509.
 Root diameter of screw shaft (dr) is 10.0 mm.

Unit: mm