

Unit: mm

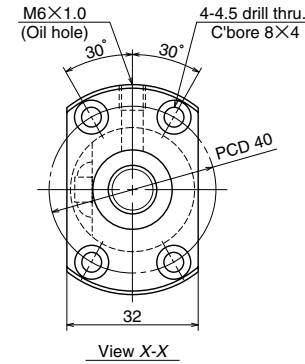
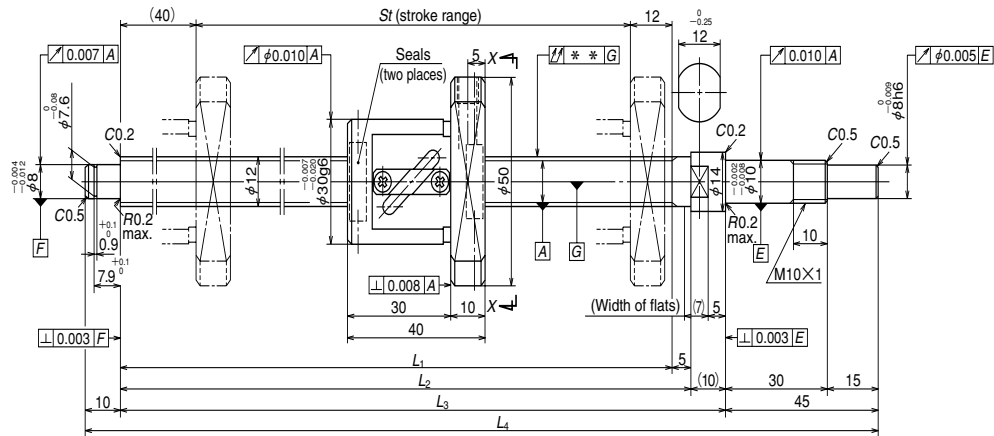

Ball screw specifications		
Shaft dia. x Lead / Direction of turn	12 x 5 / Right	
Preload / Ball recirculation	P preload / Return tube	
Ball dia. / Ball circle dia.	2.381 / 12.3	
Effective turns of balls	2.5 x 1	
Accuracy grade / Preload	C3/Z	
Basic load rating (N)	Dynamic $C_a$	3070
	Static $C_{0a}$	4670
Axial play	0	
Dynamic friction torque, (N · cm)	1.0 ~ 4.4	
Spacer ball	None	
Factory packed grease	Refer to the remarks 1. below.	
Internal spatial volume of nut (cm <sup>3</sup> )	1.2	

Ball screw No.	Stroke		Thread length			
	Nominal	Maximum	$L_1$	$L_2$	$L_3$	$L_4$
W1202KA-3P-C3Z5	200	208	260	265	275	330
W1205KA-1P-C3Z5	450	458	510	515	525	580

Lead accuracy			Shaft run-out **	Mass (Kg)	Permissible rotational speed N (min <sup>-1</sup> )
$T$	$e_p$	$v_u$			Supporting condition
0	0.012	0.008	0.040	0.47	3000
0	0.016	0.012	0.065	0.66	3000

Remarks 1. Only rust preventive agent is applied at time of delivery. Please apply lubricant (oil or grease) before use. NSK Clean Grease LG2 is recommended.  
 2. Permissible rotational speed is determined by a  $d \cdot n$  value and a critical speed. See page B509. Root diameter of screw shaft (dr) is 9.8 mm.

B  
170  
Unit: mm