

Ball screw No.	Stroke		Thread length		
	Nominal	Maximum	L_1	L_2	L_3
W1504KA-3P-C5Z10	400	427	489	504	561
W1506KA-3P-C5Z10	600	627	689	704	761
W1510KA-1P-C5Z10	1000	1027	1089	1104	1161

Remarks 1. Only rust preventive agent is applied at time of delivery. Please apply lubricant (oil or grease) before use. NSK Clean Grease LG2 is recommended.
 2. Permissible rotational speed is determined by a $d \cdot n$ value and a critical speed. See page B509. Root diameter of screw shaft (dr) is 12.2 mm.

Unit: mm

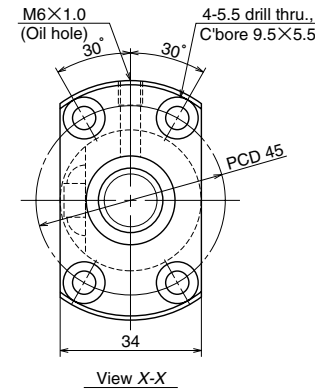

Ball screw specifications		
Shaft dia. x Lead / Direction of turn	15 x 10 / Right	
Preload / Ball recirculation	P preload / Return tube	
Ball dia. / Ball circle dia.	3.175 / 15.5	
Effective turns of balls	2.5 x 1	
Accuracy grade / Preload	C5/Z	
Basic load rating (N)	Dynamic C_a	5780
	Static C_{0a}	9430
Axial play	0	
Dynamic friction torque, (N · cm)	1.5 ~ 7.9	
Spacer ball	None	
Factory packed grease	Refer to the remarks 1. below.	
Internal spatial volume of nut (cm ³)	2.3	

Lead accuracy			Shaft run-out **	Mass (Kg)	Permissible rotational speed N (min ⁻¹)
T	e_p	v_u			Supporting condition
0	0.027	0.020	0.050	0.99	3000
0	0.035	0.025	0.065	1.2	3000
0	0.046	0.030	0.110	1.7	1610