

Unit: mm

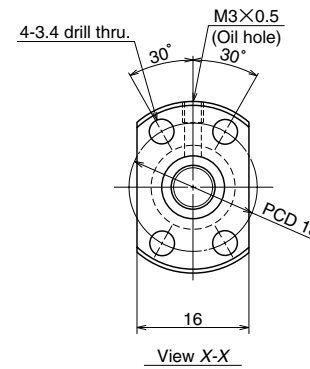
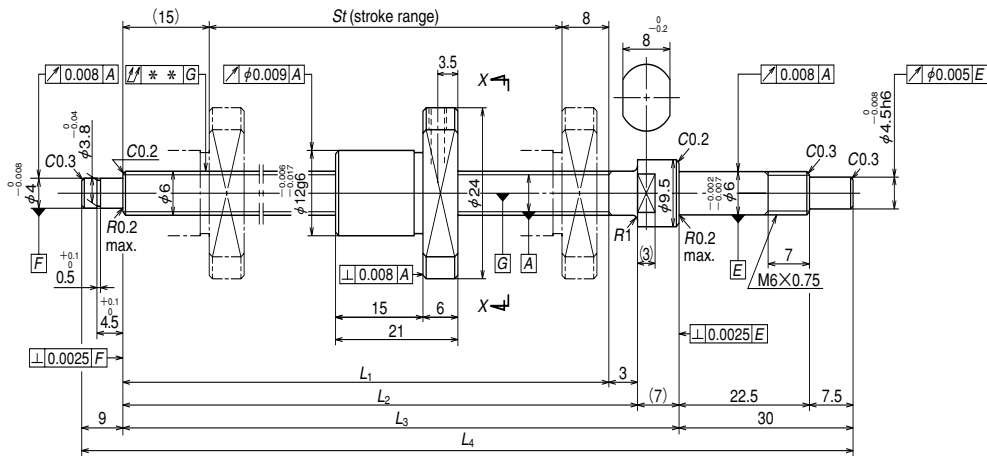

Ball screw specifications		
Shaft dia. x Lead / Direction of turn	6 x 1 / Right	
Preload / Ball recirculation	P preload / Deflector	
Ball dia. / Ball circle dia.	0.800 / 6.2	
Effective turns of balls	1 x 3	
Accuracy grade / Preload	C3/Z	
Basic load rating (N)	Dynamic C_a	470
	Static C_{0a}	680
Axial play	0	
Dynamic friction torque, (N · cm)	~1.3	
Spacer ball	None	
Factory packed grease	Refer to the remarks 1. below.	

Ball screw No.	Stroke		Thread length			
	Nominal	Maximum	L_1	L_2	L_3	L_4
W0601KA-3PY-C3Z1	100	102	125	128	135	174

Lead accuracy			Shaft run-out **	Mass (Kg)	Permissible rotational speed N (min ⁻¹)
T	e_p	v_u			Supporting condition
0	0.010	0.008	0.025	0.06	Fixed - Simple support 3000

- Remarks
1. Only rust preventive agent is applied at time of delivery. Please apply lubricant (oil or grease) before use. NSK Clean Grease LG2 is recommended.
 2. Nut does not have a seal.
 3. Permissible rotational speed is determined by a $d \cdot n$ value and a critical speed. See page B509. Root diameter of screw shaft (dr) is 5.2 mm.