

Ball screw No.	Stroke		Thread length			
	Nominal	Maximum	$L_1$	$L_2$	$L_3$	$L_4$
<b>W0802KA-1PY-C3Z1</b>	150	155	190	194	202	248

Remarks **1. Only rust preventive agent is applied at time of delivery. Please apply lubricant (oil or grease) before use.** NSK Clean Grease LG2 is recommended.  
 2. Nut does not have a seal.  
 3. Permissible rotational speed is determined by a  $d \cdot n$  value and a critical speed. See page B509. Root diameter of screw shaft (dr) is 7.2 mm.

Unit: mm

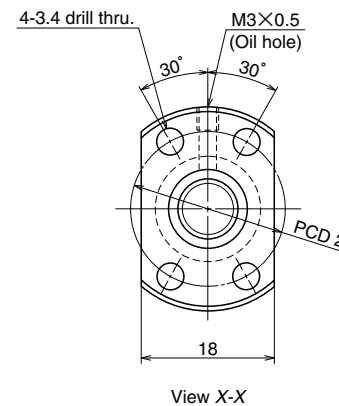

Ball screw specifications		
Shaft dia. x Lead / Direction of turn	8 x 1 / Right	
Preload / Ball recirculation	P preload / Deflector	
Ball dia. / Ball circle dia.	0.800 / 8.2	
Effective turns of balls	1 x 3	
Accuracy grade / Preload	C3/Z	
Basic load rating (N)	Dynamic $C_a$	545
	Static $C_{0a}$	955
Axial play	0	
Dynamic friction torque, (N · cm)	~1.8	
Spacer ball	None	
Factory packed grease	Refer to the remarks 1. below.	

Unit: mm

Lead accuracy			Shaft run-out **	Mass (Kg)	Permissible rotational speed N (min <sup>-1</sup> )	
$T$	$e_p$	$v_u$			Supporting condition	Fixed - Simple support
0	0.010	0.008	0.035	0.12	3000	