

Dimensions of LU Series

- LU-AL (Miniature, LU15 is equipped with ball retainer)
- LU-TL (Miniature, large mounting tap hole)
- LU-AR (Miniature, with ball retainer)
- LU-TR (Miniature, large mounting tap hole, with ball retainer)

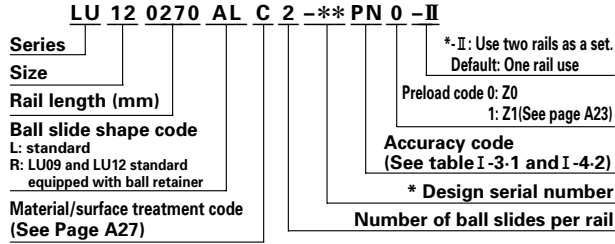

* Please note that we assign the design number, and omit the last code (II) that indicates a use of two rails as a set to finalize the reference number as product identification.

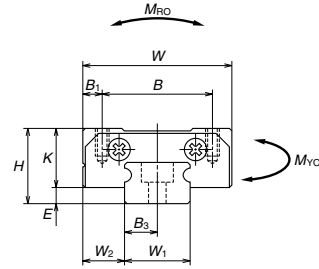

LU05TL, LU07AL
LU09AL, LU09TL

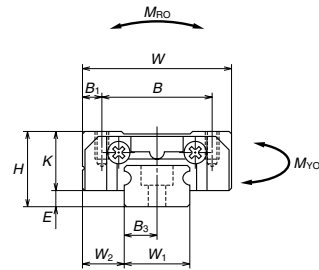

LU09AR, TR
LU12AL, TL, AR, TR
LU15AL

Table. I-5-31

Model No.	Assembly			Ball slide									Width	Height		
	Height	E	W ₂	Width	Length	Mounting hole			B ₁	L ₁	J ₁	K			W ₁	H ₁
						B	J	M × pitch × ℓ								
LU05TL	6	1	3.5	12	18	8	—	M2×0.4×1.5	2	12	6	5	5	3.2		
LU07AL	8	1.5	5	17	20.4	12	8	M2×0.4×2.4	2.5	13.6	2.8	6.5	7	4.7		
LU09AL	10	2.2	5.5	20	26.8	15	13	M2×0.4×2.5	2.5	18	2.5	7.8	9	5.5		
LU09TL							10	M3×0.5×3								
LU09AR	10	2.2	5.5	20	30	15	13	M2×0.4×2.5	2.5	20	3.5	7.8	9	5.5		
LU09TR							10	M3×0.5×3								
LU12AL	13	3	7.5	27	34	20	15	M2.5×0.45×3	3.5	21.8	3.4	10	12	7.5		
LU12TL							15	M3×0.5×3.5								
LU12AR	13	3	7.5	27	35.2	20	15	M2.5×0.45×3	3.5	21.8	3.4	10	12	7.5		
LU12TR							15	M3×0.5×3.5								
LU15AL	16	4	8.5	32	43.6	25	20	M3×0.5×4	3.5	27	3.5	12	15	9.5		

LU05TL, LU07AL, LU09TL, LU09AR, LU09TR, LU12AR and LU12TR come in stainless steel only.
 LU05TL has only two mounting tap holes in the center.
 Side seals of LU05TL, LU07AL, LU09AL and LU09TL are available on request.

LU05TL

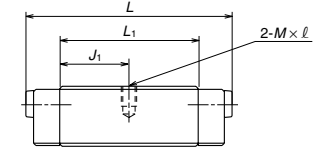

LU07AL
LU09AL, LU09TL

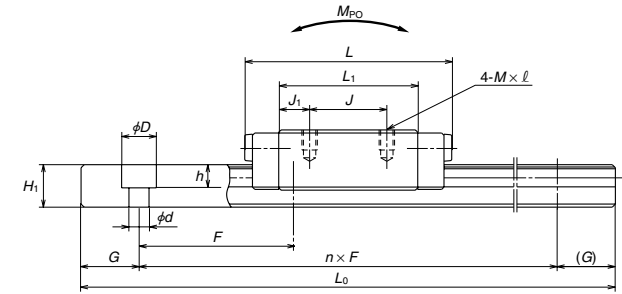

LU09AR, TR
LU12AL, TL, AR, TR
LU15AL

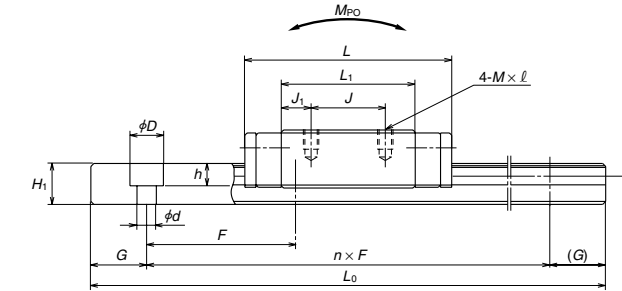

Unit: mm

Rail					Basic load rating					Ball dia.		Weight	
Pitch	Mounting bolt hole	B ₃	G (recommended)	Max. length L _{0MAX.} () for stainless	Dynamic C (N)	Static C ₀	Static moment (N-m)			D _w	Ball slide (g)	Rail (g/100mm)	
F	d × D × h						M _{RO}	M _{FO}	M _{VO}				
15	2.3×3.3×1.5	2.5	5	— (210)	545	740	1.9	1.2	1.2	1.2	4	11	
15	2.4×4.2×2.3	3.5	5	— (375)	1090	1370	4.9	2.7	2.7	1.587	10	23	
20	2.6×4.5×3	4.5	7.5	1200 (600)	1760	2220	10	6.1	6.1	2	17	35	
20	3.5×6×4.5												
20	2.6×4.5×3	4.5	7.5	— (600)	1490	2150	9.9	6.1	6.1	1.587	19	35	
20	3.5×6×4.5												
25	3×5.5×3.5	6	10	1800 (800)	2830	3500	21	11	11	2.381	38	65	
25	3.5×6×4.5												
25	3×5.5×3.5	6	10	— (800)	2830	3500	21	11	11	2.381	38	65	
25	3.5×6×4.5												
40	3.5×6×4.5	7.5	15	2000 (1000)	5550	6600	49	26	26	3.175	70	105	

To fix rail of LU05TL, use M2 x 0.4 cross-recessed pan head machine screw for precision instrument. (JCIS 10-70 No. 0 pan head machine screw No.1.)
 (JCIS : Japanese Camera Industrial Standard.)

The basic dynamic load rating is a load that furnishes 50 km rating fatigue life; it is a vertical and constant load to the ball slide mounting surface. When converting the basic dynamic load rating C to the dynamic load rating C₁₀₀ for 100 km rating fatigue life, divide the C by 1.26

LU-BL (High load type, miniature)
LU-UL (High load type, miniature, large mounting tap hole)

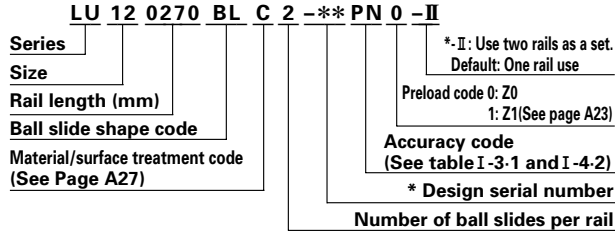

* Please note that we assign the design number, and omit the last code (II) that indicates a use of two rails as a set to finalize the reference number as product identification.

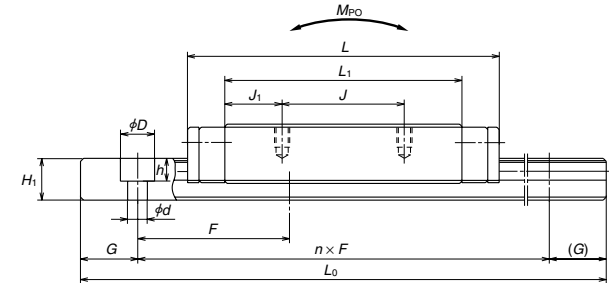
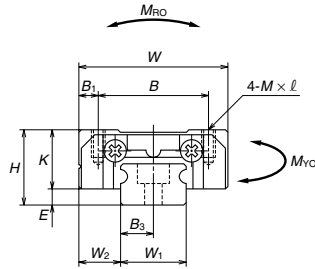

Table. I-5-32

Model No.	Assembly			Ball slide										
	Height H	E	W ₂	Width W	Length L	Mounting hole			B ₁	L ₁	J ₁	K	W ₁	Height H ₁
						B	J	M × pitch × ℓ						
LU09BL LU09UL	10	2.2	5.5	20	41	15	16	M2×0.4×2.5 M3×0.5×3	2.5	31.2	7.6	7.8	9	5.5
LU12BL LU12UL	13	3	7.5	27	47.5	20	20	M2.5×0.45×3 M3×0.5×3.5	3.5	35.3	7.65	10	12	7.5
LU15BL	16	4	8.5	32	61	25	25	M3×0.5×4	3.5	44.4	9.7	12	15	9.5

LU09UL is available only in stainless steel.
 LU15BL is equipped with ball retainer.

Rail					Basic load rating					Ball dia.	Weight	
Pitch F	Mounting bolt hole d × D × h	B ₃	G (recommended)	Max. length L _{0MAX} () for stainless	Dynamic C (N)	Static C ₀	Static moment			D _w	Ball slide (g)	Rail (g/100mm)
							M _{RO}	M _{FO}	M _{VO}			
20	2.6×4.5×3 3.5×6×4.5	4.5	7.5	1200 (600)	2600	3900	18	17	17	2	29	35
25	3×5.5×3.5 3.5×6×4.5	6	10	1800 (800)	4000	5700	34	28	28	2.381	59	65
40	3.5×6×4.5	7.5	15	2000 (1000)	8100	11300	85	69	69	3.175	107	105

The basic dynamic load rating is a load that furnishes 50 km rating fatigue life; it is a vertical and constant load to the ball slide mounting surface.
 When converting the basic dynamic load rating C to the dynamic load rating C₁₀₀ for 100 km rating fatigue life, divide the C by 1.26

Dimensions of LU Series (Interchangeable ball slide)

LAU-AR (Miniature, with ball retainer)

LAU-TR (Miniature, large mounting tap hole, with ball retainer)

LAU-AL (LAU15 is equipped with ball retainer)

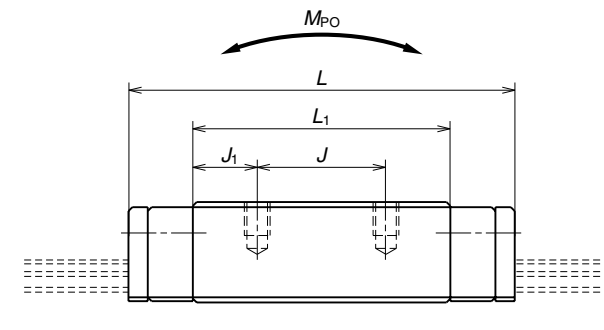
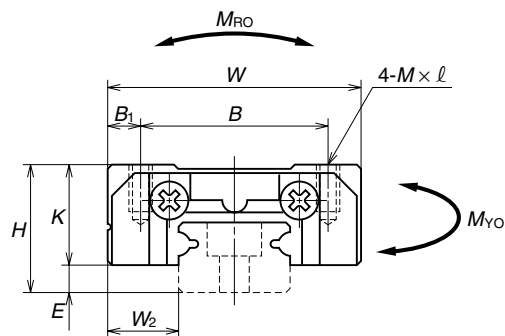
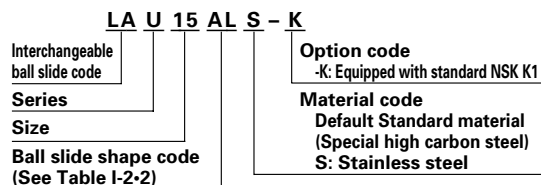

Table. I-5-33

Model No.	Assembly			Ball slide								
	Height	E	W ₂	Width W	Length L	Mounting hole			B ₁	L ₁	J ₁	K
	H					B	J	M × pitch × l				
LAU09AR	10	2.2	5.5	20	30	15	13	M2×0.4×2.5	2.5	20	3.5	7.8
LAU09TR							10	M3×0.5×3			5	
LAU12AR	13	3	7.5	27	35.2	20	15	M2.5×0.45×3	3.5	21.8	3.4	10
LAU12TR								M3×0.5×3.5				
LAU15AL	16	4	8.5	32	43.6	25	20	M3×0.5×4	3.5	27	3.5	12

LAU09 and 12 are available only in stainless steel.
LAU15AL is equipped with ball retainer.

Basic load rating					Ball dia.	Weight
Dynamic	Static	Static moment			D _w	Ball slide
C	C ₀	M _{RO}	M _{PO}	M _{YO}		(g)
(N)		(N·m)				
1490	2150	9.9	6.1	6.1	1.587	19
2830	3500	21	11	11	2.381	38
5550	6600	49	26	26	3.175	70

The basic dynamic load rating is a load that furnishes 50 km rating fatigue life; it is a vertical and constant load to the ball slide mounting surface.

When converting the basic dynamic load rating C to the dynamic load rating C₁₀₀ for 100 km rating fatigue life, divide the C by 1.26