

Nut type code: MSFD

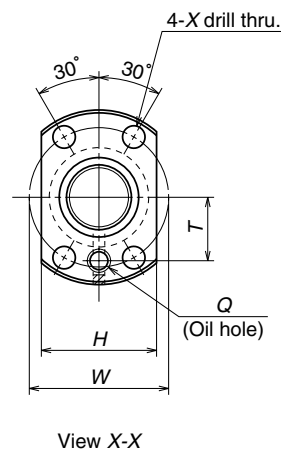

Ball screw No.	Stroke Max. L _r -L _n	Screw shaft dia. d ₁	Lead l	Ball dia. D _w	Ball circle dia. d _m	Root dia. d _r	Effective ball turns	Basic load rating (N)		Axial play Max.	Nut				
								Dynamic C _a	Static C _{0a}		Outside dia. D	Flange			Overall length L _n
												A	H	B	
W1602MS-1Y-C3T2	210	16	2	1.588	16.4	14.6	4	3510	8450	0.005	25	44	29	10	40
W1604MS-1Y-C3T2	360														
W1602MS-2Y-C3T2.5	206	16	2.5	1.588	16.4	14.6	4	3510	8450	0.005	25	44	29	10	44
W1604MS-2Y-C3T2.5	356														

- Remarks: 1. NSK support unit is recommended.
 2. Only rust preventive agent is applied at time of delivery. Please apply lubricant (oil or grease) before use.
 3. Permissible rotational speed is determined by a d · n value and a critical speed. See page B509.

dimensions		Screw shaft dimensions					Lead accuracy		Run out			Mass (Kg)	Permissible rotational speed N(min ⁻¹)				
Bolt hole	Oil hole	Threaded length L _r	Shaft end, right		Shaft end, left	Overall length L ₀	T	Deviation e _p	Variation v _u	Shaft straightness I	Nut O.D. eccentricity J			Flange perpendicularity K			
W	X		Q	T	d ₂							L ₁	L ₂		d ₃	L ₃	
35	5.5	M6×1	16	250	16.2	30	100	14.7	40	390	0	0.012	0.008	0.035	0.010	0.008	0.71
				400													
35	5.5	M6×1	16	250	16.2	30	100	14.7	40	390	0	0.012	0.008	0.035	0.010	0.008	0.73
				400													

Unit: mm