

Nut type code: ZFD

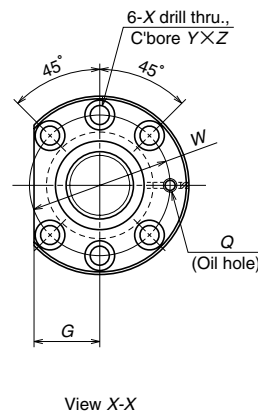

Ball screw No.	Stroke Max. L_r-L_n	Screw shaft dia. d_1	Lead l	Ball dia. D_w	Ball circle dia. d_m	Root dia. d_r	Effective ball turns Turns × Circuits	Basic load rating (N)		Preload (N)	Dynamic friction torque median (N · cm)	Nut				
								Dynamic C_a	Static C_{0a}			Flange				Overall length L_n
												Outside dia. D	A	G	B	
W3204SS-3ZY-C5Z5	323	32	5	3.175	32.75	29.4	4	14200	40700	1080	19.6	48	75	29	12	77
W3206SS-6ZY-C5Z5	523															
W3209SS-1ZY-C5Z5	823															
W3212SS-3ZY-C5Z5	1123															
W3216SS-1ZY-C5Z5	1523															
W3205SS-3ZY-C5Z10	380	32	10	6.35	33.75	27.1	3	25900	52800	1860	49.0	54	88	34	15	120
W3207SS-3ZY-C5Z10	580															
W3210SS-6ZY-C5Z10	880															
W3214SS-3ZY-C5Z10	1280															
W3218SS-3ZY-C5Z10	1680															

Remarks: 1. NSK support unit is recommended.
 2. Only rust preventive agent is applied at time of delivery. Please apply lubricant (oil or grease) before use.
 3. Permissible rotational speed is determined by a $d \cdot n$ value and a critical speed. See page B509.

dimensions				Screw shaft dimensions					Lead accuracy			Run out			Mass (Kg)	Permissible rotational speed N (min ⁻¹)		
Bolt hole		Oil hole		Threaded length L_1	Shaft end, right		Shaft end, left		Overall length L_0	Travel compensation T	Deviation e_p	Variation v_i	Shaft straightness I	Nut O.D. eccentricity J			Flange perpendicularity K	
W	X	Y	Z		Q	d_2	L_1	L_2										d_3
61	6.6	11	6.5	M6×1	400	32.3	40	29.4	200	100	650	-0.009	0.025	0.020	0.060	0.015	0.011	4.6
					600				250		950	-0.013	0.030	0.023	0.075			6.4
					900				300		1250	-0.021	0.040	0.027	0.090			8.1
					1200				300		1600	-0.028	0.046	0.030	0.120			10.2
					1600				300		2000	-0.037	0.054	0.035	0.150			12.6
70	9	14	8.5	M6×1	500	32.3	60	27.1	250	100	850	-0.010	0.027	0.020	0.075	0.019	0.013	6.2
					700				250		1050	-0.015	0.035	0.025	0.090			7.3
					1000				300		1400	-0.022	0.040	0.027	0.120			9.3
					1400				350		1870	-0.032	0.054	0.035	0.150			11.9
					1800				350		2270	-0.041	0.065	0.040	0.200			14.1

Unit: mm